

N° :

Date : 29 avr. 2020

Induction motor

2P FLSD 200LA 30kW IFT/IE3 Ex II2G Ex db IIB T4 Gb B3 400D/415D/690Y-460D 50-60Hz

Utilisation : Environment ATEX standard - Gas ; Ambiance Corrosive ; Finition - ; Zone Explosion Proof - Gas ; Type of protection Ex II2G Ex db IIB T4 Gb ; General applications ; Ambient temperature -16 +40 °C ; Maximum altitude 1000 m ; Maximum surface temperature 135°C

Motor characteristics : Cast iron housing ; Cast iron DE endshield ; Cast iron NDE endshield.



Motor definition

Protection type	Ex II2G Ex db IIB T4 Gb
Generation code	IFT
Efficiency class	IE3
Number of network phases	3
Number of speed	
Polarity	2P
Motor series	FLSD
Frame size (mm)	200
Length code	LA
HS rated power (kW)	30.000
	-
Rated speed (min-1)	2954
Maximum mechanical speed (min-1)	3600

Application	General applications
Main voltage (V)	400
Connection	DY
Motor winding (V)	400D/415D/690Y-460D
Rated Frequency (Hz)	50-60
Operation position	IM1001(IMB3)
Index of protection	IP55
Index of cooling	IC411
Insulation class	F
Finish	-
Moment of inertia J (kg.m2)	0.1410000
Motor weight (kg)	344.0

Common definitions

Paint shade	RAL2004
Paint system	C3L (1 x acrylic polyurethane finish (50µm +/- 20%))

Motor mechanical interface

Mounting flange	-	Shaft material type	Steel shaft
Drive end shaft type	IEC STANDARD shaft end	Nuance of shaft material	-
Diameter DE shaft (mm)	55m6	Second shaft extension	-
Length DE shaft (mm)	110	Diameter NDE shaft (mm)	-
DE bearing mounting	Locked	Second shaft end length (mm)	-
DE bearing type	DE ball bearing	NDE bearing type	NDE ball bearing
DE bearing	6313	NDE bearing	6313
Greasing type	Bearings with grease nipples		

Motor electrical interface

Connection network type	Cast iron ADF terminal box	Cable type	-
Connection network material	Cast iron	Cable gland material	Cable gland not supplied, holes tapped with brass and polyamide plugs
		Main cable gland type	1xM50 + 1xM20 ; With plugs
Connection network position	A	Principal cable gland position	Right (1)
Connection network orientation	up		
Connection network relative position	0		

N° :

Date : 29 avr. 2020

Induction motor - 2P FLSD 200LA 30kW IFT/IE3 Ex II2G Ex db IIB T4 Gb B3 400D/415D/690Y-460D 50-60Hz

Motor options

Vibration level	A (35µm ; 2.2mm/s ; 3.5m/s ²)	Cover	Metal cover
Balancing type	Half-key (H)	Drip proof cover option	-
Impregnation type	< 95% ; -16+40°C (T)	cooling type	-
Winding thermal protection	1 set of 3 probes PTC (winding)	Forced ventilation characteristics	-
Space heater	-	Encoder type	-
Draining plugs position	without	Encoder characteristic	-
Nameplate material	Stainless steel nameplate	Screw material	Steel screw with anticorrosive treatment
End-shield thermal protection	-	Adaptation for vibration sensor	-
Reinforced insulation system	-		

Motor characteristics (on mains supply)

Main voltage (V)	Rated Frequency (Hz)	HS rated power (kW)	Rated torque (N.m)	Rated speed (min-1)	Rated current (A)	Power factor at 4/4 of the load	Power factor at 3/4 of the load	Power factor at 2/4 of the load	Efficiency at 4/4 (IEC 60 034-2-1) of the load (%)	Efficiency at 3/4 (IEC 60 034-2-1) of the load (%)	Efficiency at 2/4 (IEC 60 034-2-1) of the load (%)
400	50	30.000	97,06	2954.00	54.07	0,86	0,82	0,75	93.37	93.64	93.11
415	50	30.000	97,06	2959.00	53.08	0.84			93.61		
460	60	30.000	80,51	3560.00	46.44	0.86			93.79		

Motor characteristics (on mains supply) 400 V 50 Hz

Starting torque (N.m)	212.23	Id / In	7.35
Average starting torque (N.m)		Id (A)	397.28
Maximum torque (N.m)	292,48	Maximum current (A)	197.7
Unload maximum starting frequency (d/h)	-	No-load current (A)	17.35
Rotor locked time (cold) (s)		Acoustic pressure level (dB(A))	77

Motor characteristics (supplied via drives)

Main voltage (V)	fn (Hz)	Pn (kW)	Nn (min-1)	In (A)	Cos Phi	Mn (10% Nn) (N.m)	Mn (20% Nn) (N.m)	Mn (33% Nn) (N.m)	Mn (50% Nn) (N.m)	Mn (N.m)	Mn (173% Nn) (N.m)	Mn (200% Nn) (N.m)
400 D	50	30	2946	59.9	0.881	97.1	97.1	97.1	97.1	97.1	0.0	0.0

N° :

Date : 29 avr. 2020

Induction motor - 2P FLSD 200LA 30kW IFT/IE3 Ex II2G Ex db IIB T4 Gb B3 400D/415D/690Y-460D 50-60Hz

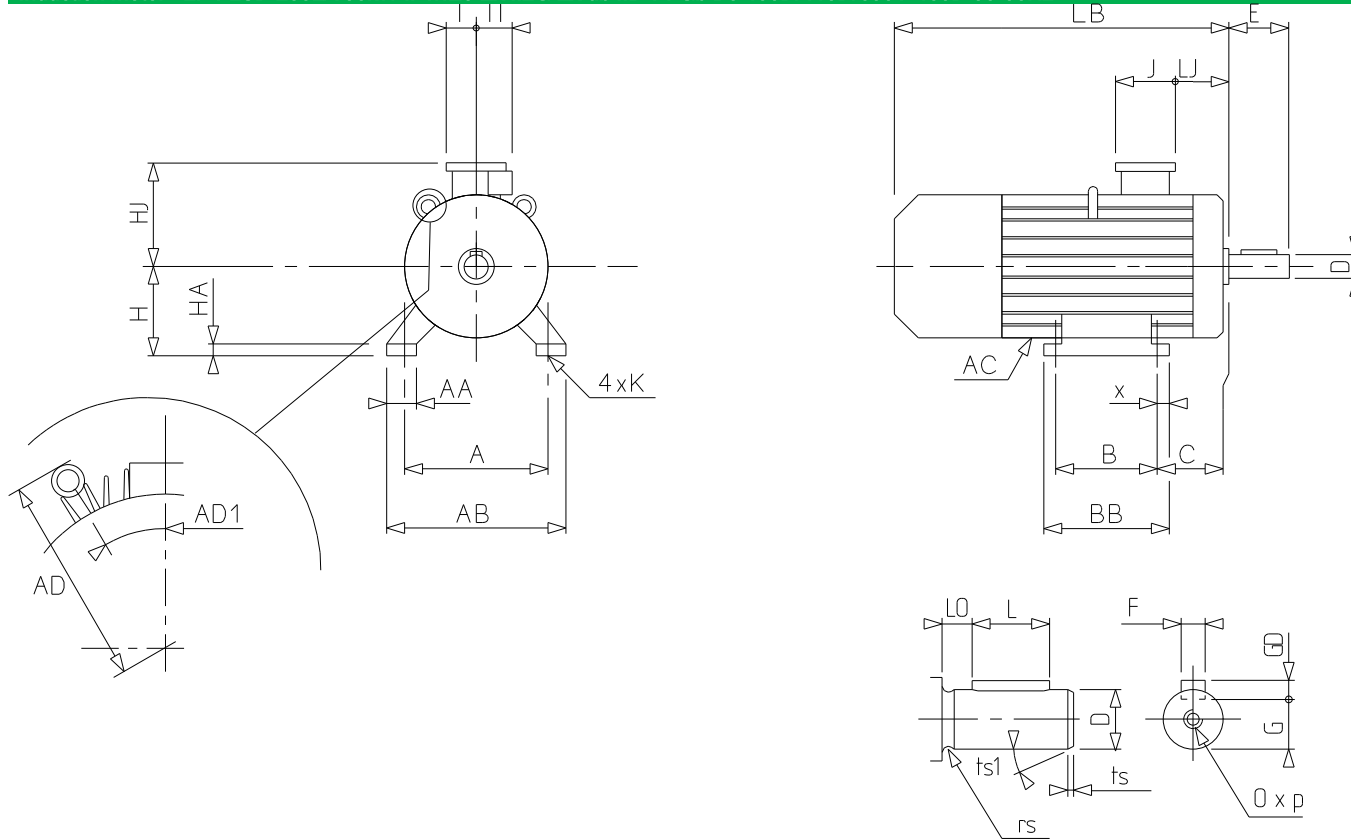

A	318
AA	81
AB	377
AC	384.00
AD1	49
B	305
BB	370
C	133.0
D	55m6
E	110
F	16
G	49
GD	10
H	200
HA	22
HJ	363.0
I	134
II	145
J	242
K	18.5
L	90
LB	776.0
LJ	54.0
LO	20
O	M20
p	42
rs	0.8
ts	1
ts1	45
x	32